



41021

137 x 67mm lever handle set.

Influenced by the 30s designs of Rachlis, Grenander, Behrens, Wagenfeld and Paul, the 41021 embraces the spirit of the Bauhaus.

Finishes: ST • SP • AS

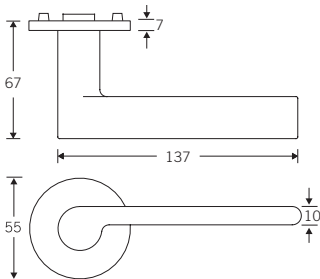

Lockset accessories

Euro profile escutcheon (pr) 41735
Bathroom turn and indicator 41735.5



41023

135 x 65mm Johannes Potente lever handle set.

When the Ulm Design College was being built in the Fifties, the Swiss architect, sculptor and designer Max Bill designed a lever handle with Ernst Moeckel based on the railway carriage handle common in Switzerland. It entered design history as the 'Ulm handle'.

Johannes Potente took this as the starting point for the 41023 model, still a compelling alternative to anonymous tubular designs.

Finishes: ST • SP • AS • AG • PB • DZ

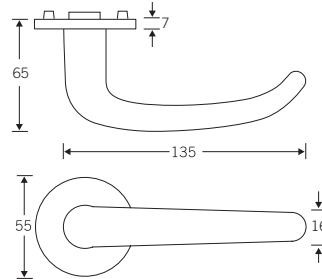

Lockset accessories

Euro profile escutcheon (pr) 41735
Bathroom turn and indicator 41735.5



41025

133 x 65mm Hartmut Weise lever handle set.

The 41025 is the nucleus of the 'FSB Light' range of handles. Its stylistic identity is clearly discernible. A straight handle grip, fashioned in cross section like the outline of a teardrop, slants away from the axis of the lever shank to which it is connected.

The 41025 possesses an elegant modesty that will please all those keen on no-frills efficiency. With the gripping surface tilted at 45 degrees, the hand fits on easily; the handle's globular section makes for comfortable and secure gripping, allowing the door to be opened or closed with little effort.

A central element in the design of the 41025 is its vividly condensed ridge of luminosity. The effect of slenderness in this unfussy door handle model is heightened by the way light and shade are manipulated.

Finishes: ST • SP • AS • AG

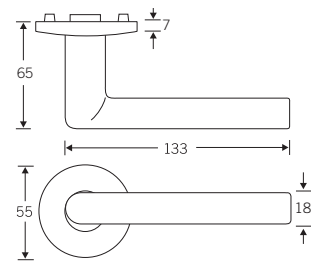

Lockset accessories

Euro profile escutcheon (pr) 41708
Bathroom turn and indicator 41708.0