

Fig.13

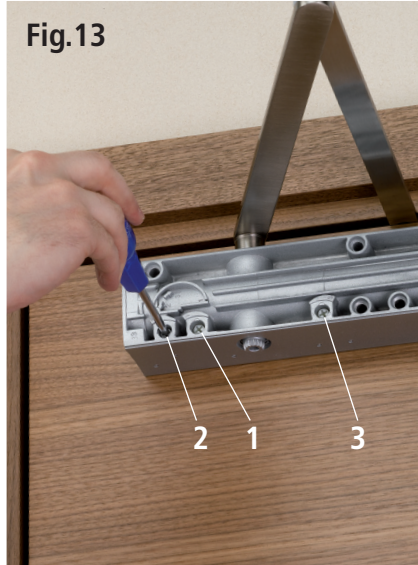

Fig.14



All Allgood door closer mechanisms are sealed for life and require little maintenance. However, a frequent check should ensure that the door closes freely and positively into the frame.

- **NOTE: Do not use power drivers on closer adjustments.**

- Check the door operation by releasing the door from the fully open position and ensure that it closes fully into the frame and that the latch (if fitted) engages fully into the strike plate. Repeat the process a few times from different opening angles to ensure door closes fully each time.
- **If the door closes too fast,** take the cover off and turn the closing speed valve (Valve 1 - Fig.13) anticlockwise with an allen key to attain desired speed.
- **If the door closes too slowly,** take the cover off and turn the closing speed valve (Valve 1 - Fig.13) clockwise to attain desired speed.
- **If the door cannot overcome the latch and close,** take the cover off and turn the latch action control valve (Valve 2 - Fig.13) anticlockwise to attain the desired action.
- **If the door slams as it comes to a close,** take the cover off and turn the latch

## biannual checks

action control valve (Valve 2 - Fig.13) clockwise to attain the desired action.

- If the door fully opens and hits a wall, take the cover off and turn the backcheck valve (Valve 3 - Fig.13) clockwise until a satisfactory condition is reached.

**If the door is too difficult to open,** take the cover off and turn the power control (Fig.14) anticlockwise with an allen key to attain desired speed.

**If the door is too light to open** and is affected by wind and air pressures, take the cover off and turn the power control (Fig.14) clockwise with an allen key to attain desired speed.

- The fixings of the closer body and the bracket are subject to stress and should be carefully checked to make sure they are tight.
- Apply a little machine oil to the moving joints of the arm and bracket.
- Check the door closer for dirt and grease and wipe clean as directed in the 'Care of finishes' section (page 19-20).

## biannual checks



### Contego Satin Copper

Wipe clean with a solution of washing-up liquid using a soft cloth or sponge. Rinse and dry with a dry soft cloth. Do not use solvent based or abrasive cleaning materials.

**Finish prefix:** CS

Antimicrobial  
Copper



### Contego Polished Copper

Wipe clean with a solution of washing-up liquid using a soft cloth or sponge. Rinse and dry with a dry soft cloth. Do not use solvent based or abrasive cleaning materials.

**Finish prefix:** CP

Antimicrobial  
Copper



### Bronze

To protect the bronze items and to maintain a sheen, a regular application of an approved brass polish is required.

**Finish prefix:** BR



### Brass

Polishing is the only way to prevent tarnishing. A weekly polish with a brass cleaner and a soft cloth will allow the brass products to maintain their original state.

**Finish prefix:** PB



### Satin Stainless Steel

Wipe clean with a medium strength detergent or white spirit using a soft cloth or sponge. Rinse and dry with a dry soft cloth. In the event of dirt having accumulated through neglect, application of aerosol lubricant prior to standard cleaning is recommended. A harsh brush should never be used.

**Finish prefixes:** SS • ST



### Polished Stainless Steel

Wipe clean with a medium strength detergent or white spirit using a soft cloth or sponge. Rinse and dry with a dry soft cloth. In the event of dirt having accumulated through neglect, application of aerosol lubricant prior to standard cleaning is recommended. A harsh brush should never be used.

**Finish prefixes:** PS • SP



### Anodised Aluminium

Wipe clean with a solution of washing-up liquid using a soft cloth or sponge. Rinse and dry with a dry soft cloth. Do not use solvent based or abrasive cleaning materials.

**Finish prefixes:** MA • AS



### Colour Coated / PVD

Wipe clean with a solution of washing-up liquid using a soft cloth or sponge. Rinse and dry with a dry soft cloth. Do not use solvent based or abrasive cleaning materials.

**Finish prefixes:** TA • BF • BS • BD • BL • BT • GT